

PRODUCT DATA SHEET

DURO-LAST POLY-PLATE

Description:

The Duro-Last® Poly-Plate is 0.335 inch (8.5 mm) thick, 2-inch (51 mm) diameter and manufactured using a glass-filled polycarbonate blend. Polycarbonate has proven weatherability and resiliency. Duro-Last® Poly-Plates are packaged and sold in quantities of 1,000.

Duro-Last® Poly-Plates include a recessed 0.280 inch (6.4 mm) diameter hole in the center to prevent the screw head from coming in contact with the Duro-Last® Roofing membrane. Duro-Last® Poly-Plates have 10 “cleats” on the bottom to enhance the wind uplift characteristic of the Duro-Last® membrane.

The Duro-Last® Poly-Plate is a long-lasting and durable plate that is only available only from Duro-Last®, Inc.

Installation:

The Duro-Last® 2” Poly-Plate must be used for securing the Duro-Last® membrane to the deck along the prefabricated fastening tab of the sheet parallel to the tab direction. The outside edge of the Poly-Plate must be installed flush to the edge of the fastening tab (see detail 1190).

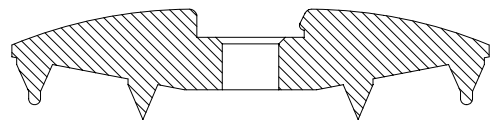
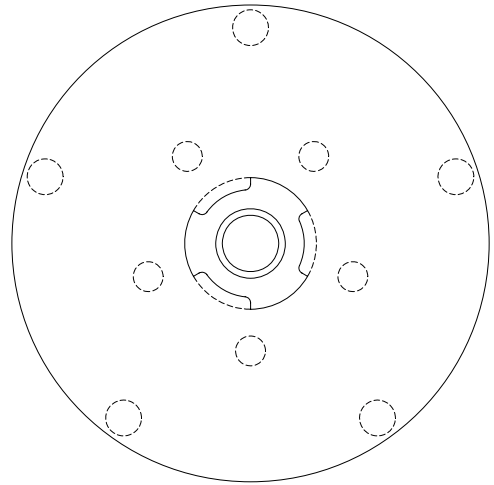

For more information on these and other Duro-Last Products, contact the Duro-Last Engineering Services Department.

E-Mail: engineering@duro-last.com

"Duro-Last" and the interlocking "DL" are registered marks owned by Duro-Last Roofing, Inc. October 2005



Duro-Last Roofing, Inc.
525 Morley Drive
Saginaw, MI 48601
Ph: 1-800-248-0280
Fax: 1-800-432-9331
www.duro-last.com