



PRODUCT DATA SHEET

DURO-LAST DRIP EDGE

Description:

Duro-Last® patented Drip Edge (available in white, gray, and tan) is fabricated from a rigid exterior vinyl with a 6" skirt (available in white, gray, and tan) made from a high tenacity low-shrink weft-inserted 18 x 14, 1000 Denier polyester fabric that has been coated with a proven thermoplastic alloy. Duro-Last® patented drip edge may be used as perimeter for the Duro-Last® roofing system.

Duro-Last® Drip Edge is available in two face sizes: 2½" (51 mm) and 4" (102 mm). The Drip Edge is available in 10' (3 m) lengths. Duro-Last® has pre-punched slotted holes 8" (203 mm) on center for fastening of the Drip Edge. Duro-Last® provides joint clips for the face to improve and enhance aesthetics. Special orders can be produced to alter the skirt size and color to provide for the desired aesthetics. (Example: white material on tan Drip Edge or tan material on white Drip Edge)

Duro-Last® Drip Edge has been successfully tested by Factory Mutual Research Corporation as an approved edging component for FM 1-90 roof assemblies.

Duro-Last® Drip Edge is packed in either small tubes or large boxes in multiples of 10' (3 m). A small tube will contain 50 linear feet (15.2 m) of 2½" (51 mm) face Drip Edge, while a large box will contain up to 200 linear feet (61 m) of 2½" (51 mm) face Drip Edge. The 4" (102 mm) face Drip Edge can be packaged in a large box holding a maximum of 140 linear feet.

Installation:

Duro-Last® Drip Edge skirting should be heat-welded (hot-air) to the field membrane. Drip edge with attached skirt should be fastened to deck/wood nailers only with approved fasteners, spaced 8 inches (.2 m) on center. Duro-Last® Drip Edge can be installed on any flat edge including the top of parapet walls. It is necessary to allow 1-inch (25 mm) spacing at all joints; the joint clips will cover this space. Pre-manufactured outside Duro-Last® Drip Edge drip edge corners may be used for aesthetic value (See detail 3080 & 3150).

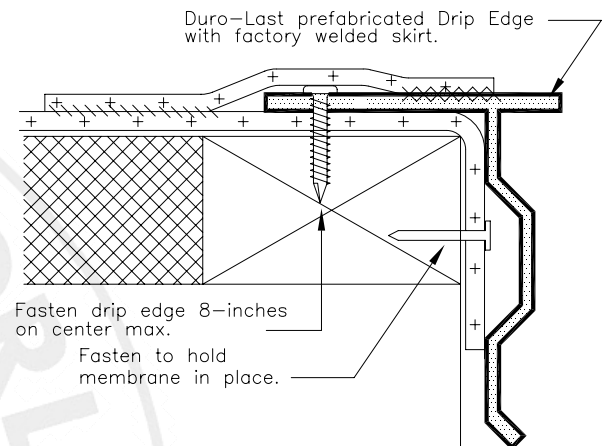
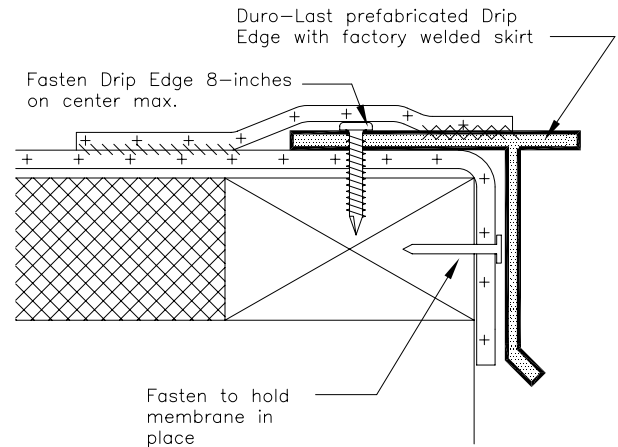

For more information on these and other Duro-Last Products, contact the Duro-Last Engineering Services Department.

E-Mail: engineering@duro-last.com

"Duro-Last" and the interlocking "DL" are registered marks owned by Duro-Last Roofing, Inc. October 2005



Duro-Last Roofing, Inc.
525 Morley Drive
Saginaw, MI 48601
Ph: 1-800-248-0280
Fax: 1-800-432-9331
www.duro-last.com